

Protected Places Order 2009

Table of Contents

Enacting Formula

1 Citation and commencement

2 Premises declared to be protected places

THE SCHEDULE

No. S 255

PROTECTED AREAS AND PROTECTED PLACES ACT (CHAPTER 256)

PROTECTED PLACES ORDER 2009

In exercise of the powers conferred by section 5(1) of the Protected Areas and Protected Places Act, the Minister for Home Affairs hereby makes the following Order:

Citation and commencement

1. This Order may be cited as the Protected Places Order 2009 and shall come into operation on 3rd June 2009.

Premises declared to be protected places

2. The premises described in the second column of the Schedule are hereby declared to be protected places for the purposes of the Act, and no person shall be in those premises unless he is in possession of a pass-card or permit issued by the authority specified in the first column of the Schedule or has received the permission of an authorised officer on duty at the premises to enter the premises.

THE SCHEDULE

<i>First column</i>			<i>Second column</i>																																				
The Authority			Protected Place																																				
Director, A*Star Centre	Biological	Resource	(1) BIOLOGICAL RESOURCE CENTRE — BLOCK 1, BASEMENT 1 — MEZZANINE LEVEL. All that area comprised in part of State Land Lot 3886W in Mukim No. 3 occupied by “BIOLOGICAL RESOURCE CENTRE — BLOCK 1, BASEMENT 1 — MEZZANINE LEVEL” containing an area of about 179.7 square metres and bounded approximately as follows: Commencing at the corner of the aforesaid “BIOLOGICAL RESOURCE CENTRE — BLOCK 1, BASEMENT 1 — MEZZANINE LEVEL” which point is 31,814.31 metres North and 23,331.86 metres East of the Singapore Land Authority SVY 21 Datum, the boundaries run along successive lines of co-ordinates approximately as follows:																																				
			<table><tr><th><i>Northing</i></th><th><i>Easting</i></th></tr><tr><td>31,814.31</td><td>23,331.86</td></tr><tr><td>31,814.11</td><td>23,332.85</td></tr><tr><td>31,812.64</td><td>23,332.54</td></tr><tr><td>31,812.31</td><td>23,334.08</td></tr><tr><td>31,812.82</td><td>23,334.19</td></tr><tr><td>31,811.09</td><td>23,339.01</td></tr><tr><td>31,810.63</td><td>23,338.83</td></tr><tr><td>31,810.11</td><td>23,340.24</td></tr><tr><td>31,810.27</td><td>23,340.30</td></tr><tr><td>31,810.14</td><td>23,340.63</td></tr><tr><td>31,810.46</td><td>23,340.75</td></tr><tr><td>31,807.73</td><td>23,348.30</td></tr><tr><td>31,810.23</td><td>23,348.14</td></tr><tr><td>31,806.71</td><td>23,349.56</td></tr><tr><td>31,801.46</td><td>23,347.65</td></tr><tr><td>31,803.76</td><td>23,341.29</td></tr><tr><td>31,798.13</td><td>23,339.23</td></tr></table>	<i>Northing</i>	<i>Easting</i>	31,814.31	23,331.86	31,814.11	23,332.85	31,812.64	23,332.54	31,812.31	23,334.08	31,812.82	23,334.19	31,811.09	23,339.01	31,810.63	23,338.83	31,810.11	23,340.24	31,810.27	23,340.30	31,810.14	23,340.63	31,810.46	23,340.75	31,807.73	23,348.30	31,810.23	23,348.14	31,806.71	23,349.56	31,801.46	23,347.65	31,803.76	23,341.29	31,798.13	23,339.23
<i>Northing</i>	<i>Easting</i>																																						
31,814.31	23,331.86																																						
31,814.11	23,332.85																																						
31,812.64	23,332.54																																						
31,812.31	23,334.08																																						
31,812.82	23,334.19																																						
31,811.09	23,339.01																																						
31,810.63	23,338.83																																						
31,810.11	23,340.24																																						
31,810.27	23,340.30																																						
31,810.14	23,340.63																																						
31,810.46	23,340.75																																						
31,807.73	23,348.30																																						
31,810.23	23,348.14																																						
31,806.71	23,349.56																																						
31,801.46	23,347.65																																						
31,803.76	23,341.29																																						
31,798.13	23,339.23																																						

31,800.90	23,331.68
31,800.95	23,331.69
31,801.27	23,330.23
31,806.59	23,331.33
31,807.05	23,329.22
31,813.07	23,330.48
31,812.85	23,331.56

to the point of commencement.

The boundaries of “BIOLOGICAL RESOURCE CENTRE — BLOCK 1, BASEMENT 1 — MEZZANINE LEVEL” are more particularly delineated in the Plan Ref No. TTK2612/2007/6466-A1 set out below.

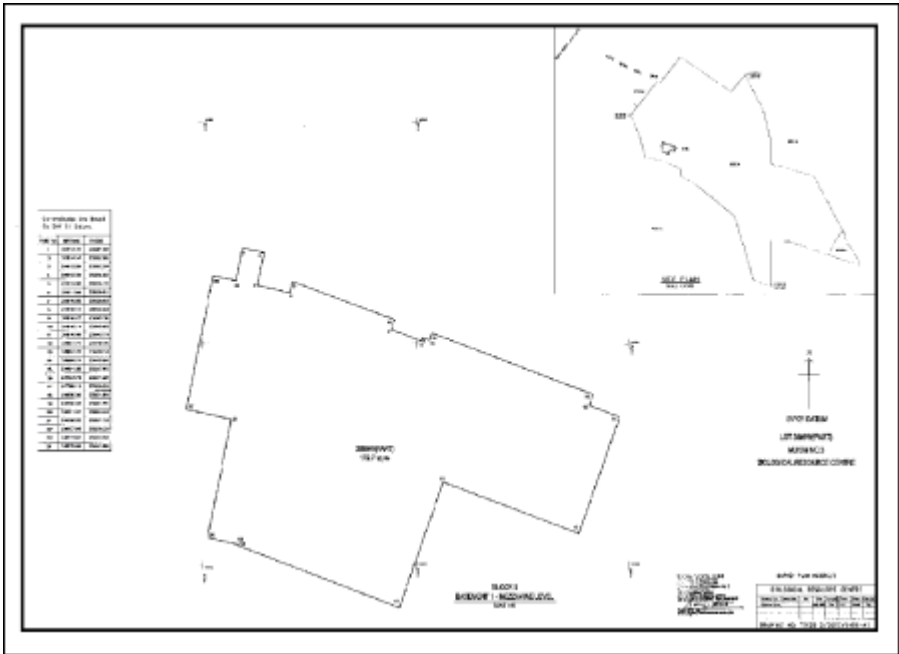

First column

Second column

The Authority

Protected Place

Director,
A*Star Biological Resource Centre

(2) BIOLOGICAL RESOURCE CENTRE — BLOCK 1,
BASEMENT 1.

All that area comprised in part of State Land Lot 3886W in Mukim No. 3 occupied by “BIOLOGICAL RESOURCE CENTRE — BLOCK 1, BASEMENT 1” containing an area of about 179.7 square metres and bounded approximately as follows:

Commencing at the corner of the aforesaid “BIOLOGICAL

RESOURCE CENTRE — BLOCK 1, BASEMENT 1” which point is 31,814.31 metres North and 23,331.86 metres East of the Singapore Land Authority SVY 21 Datum, the boundaries run along successive lines of co-ordinates approximately as follows:

<i>Northing</i>	<i>Easting</i>
31,814.31	23,331.86
31,814.11	23,332.85
31,812.64	23,332.54
31,812.31	23,334.08
31,812.82	23,334.19
31,811.09	23,339.01
31,810.63	23,338.83
31,810.11	23,340.24
31,810.27	23,340.30
31,810.14	23,340.63
31,810.46	23,340.75
31,807.73	23,348.30
31,807.23	23,348.14
31,806.71	23,349.56
31,801.46	23,347.65
31,803.76	23,341.29
31,798.13	23,339.23
31,800.90	23,331.68
31,800.95	23,331.69
31,801.27	23,330.23
31,806.59	23,331.33
31,807.05	23,329.22
31,813.07	23,330.48
31,812.85	23,331.56

to the point of commencement.

The boundaries of “BIOLOGICAL RESOURCE CENTRE — BLOCK 1, BASEMENT 1” are more particularly delineated in the Plan Ref No. TTK2612/2007/6466-A set out below.