

Protected Places (No. 6) Order 1996

Table of Contents

Enacting Formula

1

2

THE SCHEDULE

No. S 532

PROTECTED AREAS AND PROTECTED PLACES ACT (CHAPTER 256)

PROTECTED PLACES (NO. 6) ORDER 1996

In exercise of the powers conferred by section 5(1) of the Protected Areas and Protected Places Act, the Minister for Home Affairs hereby makes the following Order:

1. This Order may be cited as the Protected Places (No. 6) Order 1996 and shall come into operation on 20th December 1996.

2. The premises described in the second column of the Schedule are hereby declared to be protected places for the purposes of the Protected Areas and Protected Places Act, and no person shall be in those premises unless he is in possession of a pass-card or permit issued by the authority specified in the first column of the Schedule or has received the permission of an authorised officer on duty at the premises to enter the premises.

THE SCHEDULE

First column

Second column

(1) SENOKO GASWORKS PLOT (1)

All that area comprised partly on plot (1) of lot 2344 pt Mukim No. 13 Sembawang at Senoko Avenue occupied by "SENOKO GASWORKS PLOT (1)" containing an area of about 57,993.3 square metres and bounded approximately as follows:

Commencing at the most North-East corner of the perimeter fence of the aforesaid "SENOKO GASWORKS PLOT (1)" which point is 50,197.897 metres North and 25,310.964 metres East of the Survey Department origin of co-ordinates, the boundaries run along successive lines of fence of bearings and distances as under:

<i>Bearing</i>	<i>Distance in metres</i>
212° 31'	88.7 along fence
272° 5'	0.9 along fence
236° 31'	2.2 along fence
237° 14'	7.9 along gate
237° 15'	22.0 along fence
191° 4'	2.1 along fence
238° 9'	24.1 along fence
237° 27'	17.9 along fence
237° 18'	34.1 along fence
237° 4'	10.8 along fence
237° 29'	48.7 along fence
281° 35'	22.1 along fence
281° 7'	13.6 along fence
237° 41'	27.5 along fence
237° 5'	7.9 along gate
147° 54'	7.9 along fence
208° 52'	4.6 along fence
142° 57'	5.0 along fence
86° 17'	4.1 along fence
147° 15'	21.9 along fence
237° 14'	36.9 along fence

237° 19'	32.3 along fence
237° 53'	10.0 along fence
326° 1'	39.0 along fence
326° 0'	39.1 along fence
325° 55'	83.9 along fence
325° 16'	2.7 along gate
325° 16'	5.1 along fence
326° 26'	11.8 along fence
326° 4'	18.9 along fence
326° 20'	15.1 along fence
337° 8'	3.1 along fence
345° 23'	2.9 along fence
354° 10'	3.0 along fence
11° 45'	3.0 along fence
32° 41'	3.0 along fence
51° 0'	3.0 along fence
62° 06'	3.1 along fence
71° 49'	11.8 along fence
73° 28'	47.7 along fence
72° 30'	27.0 along fence
74° 21'	9.0 along fence
76° 0'	14.9 along fence
76° 46'	50.4 along fence
76° 56'	30.6 along fence
77° 40'	22.9 along fence
77° 43'	37.6 along fence
77° 24'	14.9 along fence
78° 45'	4.7 along gate
77° 51'	48.0 along fence
77° 43'	50.6 along fence
80° 55'	3.4 along fence
89° 39'	6.2 along fence
95° 33'	3.2 along fence

108° 49'	5.9 along fence
116° 41'	12.0 along fence
121° 22'	3.0 along fence
125° 20'	5.9 along fence
129° 28'	27.1 along fence

to the point of commencement.

The boundaries of “SENOKO GASWORKS PLOT (1)” are more particularly delineated in the Plan set out below.

SENOKO GASWORKS PLOT (1)

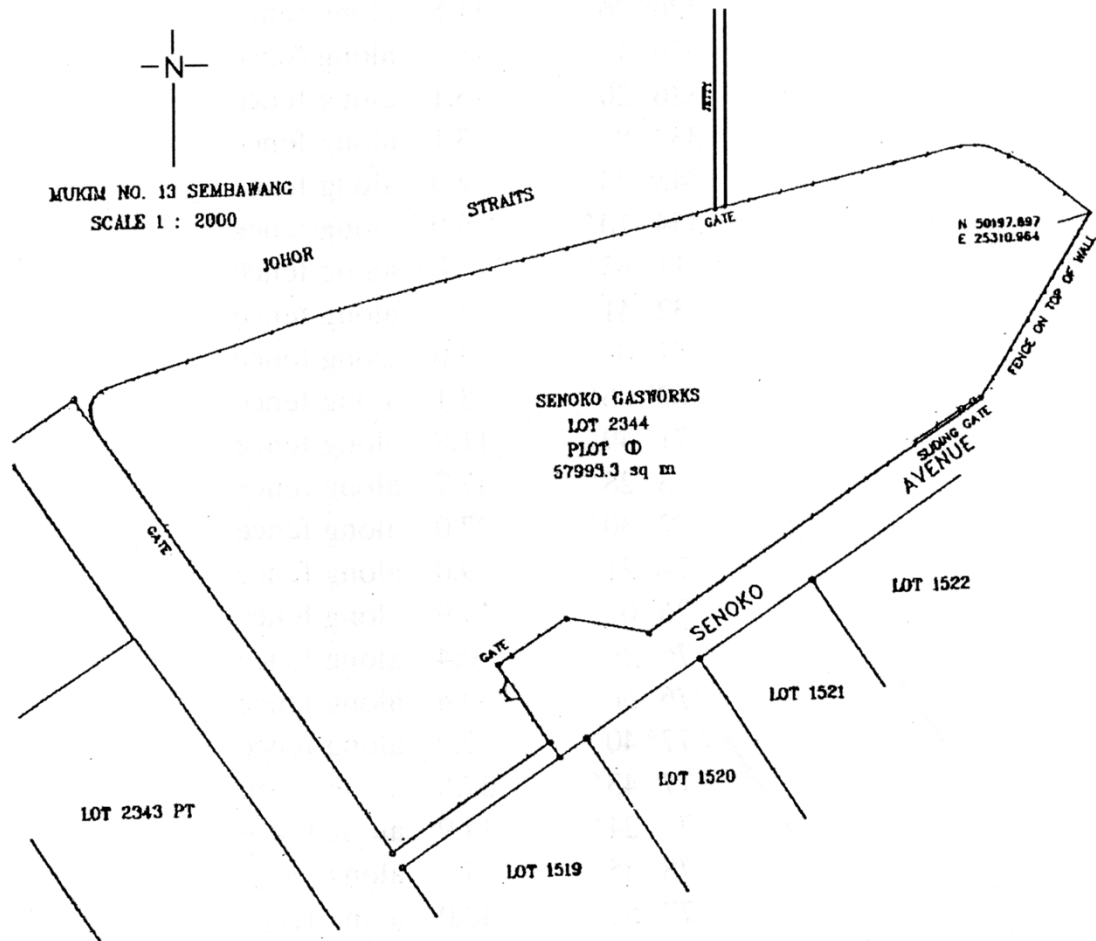

First column

The Authority

Second column

Protected Place

All that area comprised partly on plot (2) of lot 2343 pt Mukim 13 Sembawang at Senoko Road occupied by “SENOKO GASWORKS PLOT (2)” containing an area of about 9,402.1 square metres and bounded approximately as follows:

Commencing at the most North-East corner of the perimeter fence of the aforesaid “SENOKO GASWORKS PLOT (2)” which point is 50,118.344 metres North and 24,838.528 metres East of the Survey Department origin of co-ordinates, the boundaries run along successive lines of fence of bearings and distances as under:

<i>Bearing</i>	<i>Distance in metres</i>
125° 50'	10.9 along fence
129° 35'	9.9 along fence
146° 9'	13.1 along fence
145° 52'	26.9 along fence
146° 0'	16.3 along fence
146° 0'	2.8 along gate
146° 0'	14.8 along fence
146° 35'	11.1 along fence
237° 7'	36.0 along fence
237° 22'	47.1 along fence
327° 43'	12.6 along gate
327° 18'	51.2 along fence
327° 2'	51.8 along fence
327° 33'	10.1 along fence
70° 28'	30.4 along fence
70° 37'	36.0 along fence
88° 30'	11.2 along fence

to the point of commencement.

The boundaries of “SENOKO GASWORKS PLOT (2)” are particularly delineated in the Plan set out below.